



TABLE TOP MOTORIZED POP UP POWER & DATA UNIT

—— Z-22 Popup Socket ——



ACCESS PRODUCT INCORPORATED



Access Technology Co., Ltd.
www.accessproductcn.com
access@accessproductcn.com

**Table Top Motorized Pop Up Power & Data Unit
Z-22 Series Product Highlights**



SINGLE TOUCH OPERATION



DUAL WIRELESS CHARGING ON SURFACE



KEEP THE SURFACE CLEAN BY HIDING THE WIRES INSIDE THE UNIT



3C AND ETL CERTIFIED

DAISY CHAIN CAPABILITY FOR THE Z-22

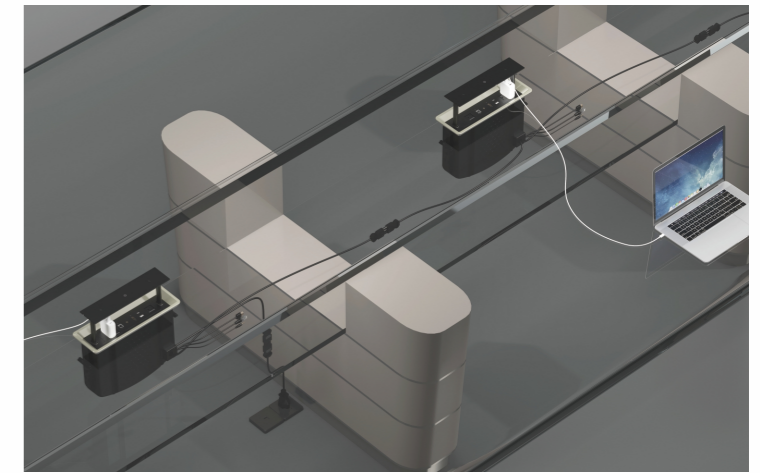
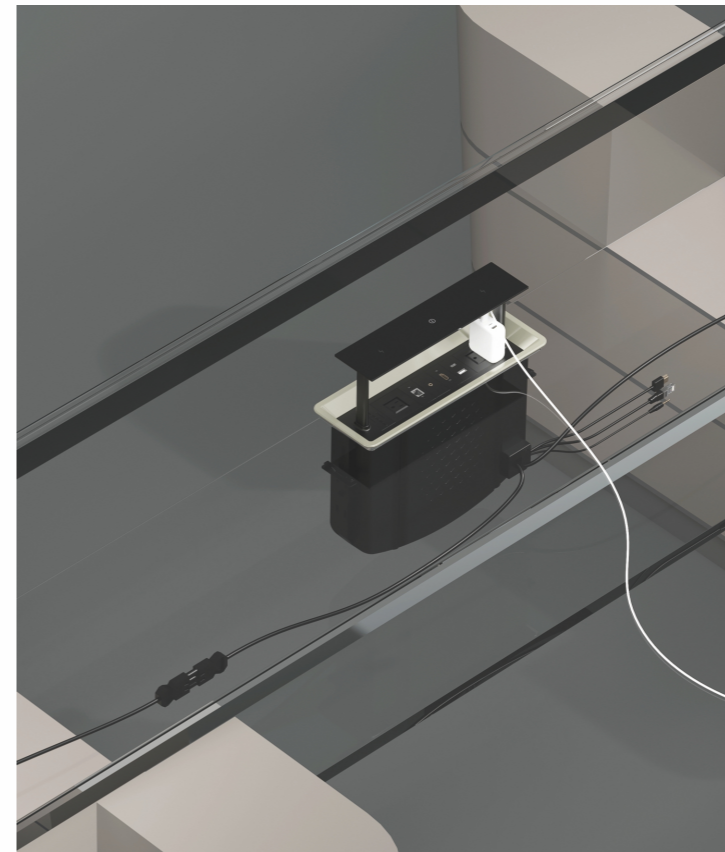

PRODUCT SIZE

350mm x 273mm x 107mm (13.78 x 10.75 x 4.21 inches)

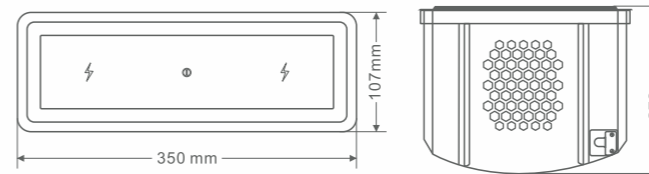

INSTALLATION GUIDE

[1] Cut out size: 346 x 113 mm (13.4 x 10.8 inches)

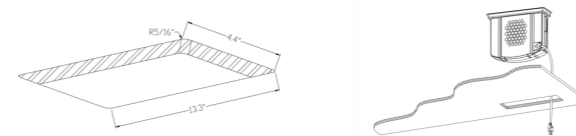

[2] Attach the 2 included brackets, starting from the bottom and snug it to the top of the furniture;

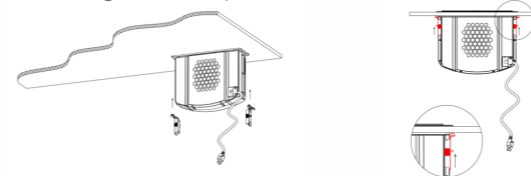

[3] Check to ensure the unit is securely installed. Plug in the cords to the appropriate components.

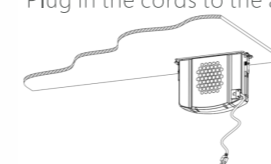

STANDARD CONFIGURATION

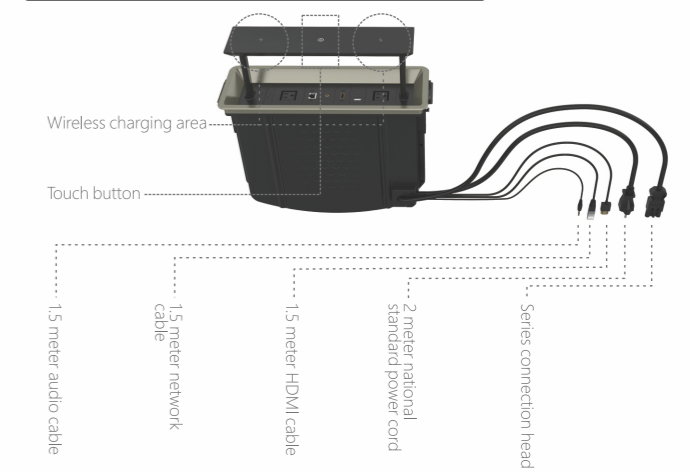

Product size: 350 x 273 x 107mm
 AC input: 100-240V AC 50/60Hz, 10A
 Socket output: 100-240V AC 50/60Hz, 10A
 USB-A output: 5V/3A, 9V/2.22 A, 12V/1.67A
 Type-C output: 5V/3A, 9V/2.22 A, 12V/1.67
 USB-A+ Type-C charging module total output: 18W Max
 Wireless charging output: 10W per port, total output 15W
 Operating temperature: -15 ~ 40 °C/5 ~ 104 °F

CUSTOMIZABLE CONFIGURATION

You can freely configure the required number of modules, module functions, and various line lengths according to your needs.

